

## PETITE DESKTOP EASEL



### PRACTICAL FOR PRESENTING YOUR MENUS, PROMOTIONS AND MORE

Petite Desktop Easel is made of beech wood. Lacquered finish is applied for long term use. Its modern and traditional combination wooden look creates a friendly atmosphere to your business, menu or announcements. Adjustable back support helps to achieve perfect placement. Its foldable flat design is space saving. Optional chalk panel max. size is 8.27" x 11.70"

### KEY SELECTION ATTRIBUTES

- \* Practical and foldable Beech Wood Easel, suitable for desktop useage.
- \* Perfect way to present/change the menus, messages, announcements or promotions.
- \* One set includes beech wood triple feet easel with lacquered finish for durability and foldable/adjustable back support for achieving perfect placement and stability.
- \* Suitable for use with dry-wipe chalkboard for changing notes easily. Maximum size of the optional chalkboard is 8.27" x 11.70"
- \* Please do not forget to order separately.
- \* Optional accessories like chalkboard markers are not included. Please order separately.
- \* Easy to fold flat for easy storage.
- \* Packed unassembled in a sturdy box. Assembly in 10 seconds.



COLOURS  
IN STOCK



Natural  
Wood

SUITABLE FOR

Petite Desktop Easel can be used for INDOOR applications, for signage needs in many locations like shopping centers, markets, groceries, hotels, offices airports, shops and stores, hospitals, schools, apartments and many more.

FEATURES



EXPLODED VIEW



TECHNICAL DRAWING

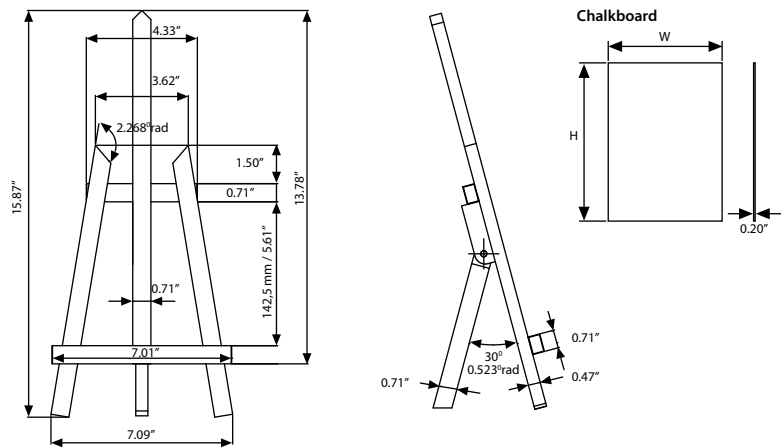

ARTICLES

ARTICLE	SIZE (x-y)	DESCRIPTION	WEIGHT	PACKING SIZE
			WITH PACKING	*W X H X D
UWDEPN0010	16.14" X 7.08"	Natural Wood - Black Chalkboard	0.683 lbs	8.26" X 16.92" X 2.16

OPTIONAL ACCESSORIES



Colour chalkboard marker. 0.39" wide. 5 Pcs. / UYAKLM1251



White chalkboard marker for Wood Display. 0.39" wide. 3 Pcs / UYAKLM1250



Chalkboard. 0.11".

CHALKBOARD			
ARTICLE	SIZE	W	H
UPCUWD00A4	8.27" x 11.70"	8.5"	11.81"
UPCUWD00A5	5.83" x 8.27"	5.8"	8.3"
UPCUWD00A6	4.13" x 5.83"	4.1"	5.8"
UPCUWD0081	8.50 X 11"	8.5"	11.14"
UPCUWD0058	5.5" X 8.5"	5.8"	8.62"

PHYSICAL DATA

**Material**  
Beech Wood triple feet easel.

**Surface Finish**  
Beech Wood triple feet with lacquered finish.

**Warranty**  
All products are guaranteed for 1 years by MT Displays with below conditions:  
[Warranty Conditions](#)

**Storage Conditions**  
Goods should be stored at 32F° to 77°F in a dry place. Store in the original package.

**Installation Considerations**  
Packed unassembled in a sturdy box. Assembly in 10 seconds. One set includes beech wood triple

feet easel with lacquered finish for durability and foldable/adjustable back support for achieving perfect placement and stability. Suitable for use with dry-wipe chalkboard for changing notes easily. Maximum size of the optional chalkboard is 8.27" x 11.70". Please do not forget to order separately. Optional accessories like chalkboard markers are not included. Please order separately. Easy to fold flat for easy storage.

**Design Considerations**  
Practical and foldable Beech Wood Easel, suitable for desktop usage. Perfect way to present/ change the menus, messages, announcements or promotions.

**Cleaning and Disinfecting**  
Clean your displays, with damp microfiber clothes, rinsed with simply water or warm, soapy or gentle shampooed water. Avoid using vinegar, abrasive, acidic, alcohol-based or heavy cleaners or cleaners containing Ammonia. Only after cleaning the product, if needed, simply apply disinfectant or sanitizer that is in compliance with your local guidelines and regulations.



# INSTALLATION INSTRUCTIONS

Petite Desktop Easel / 1011397H000

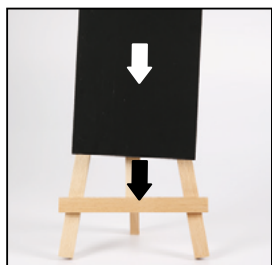
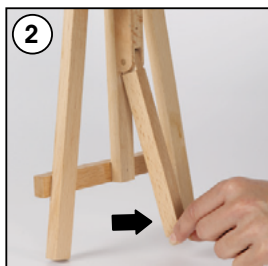
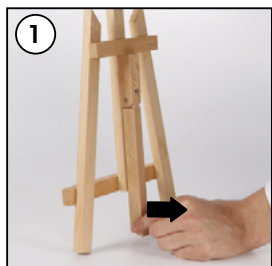

**CAUTION :** Panel is not included in the pack.  
Usable panel size max. A4.



- Please inform the order number on the product or on the carton (e.g. 1/110001394-460) to the place that you have made the purchase if any problem with the product occurs.
- All rights reserved. All pictures, figures and writings are secured internationally by copy-right law. Infringements will be sued by civil and legal law.

This technical sheet's contents are all subject to update and modification at MT Displays' exclusive discretion. There is nothing official about this document. For final and legally binding information, please get in touch with the sales staff at MT Displays.



T: +1 855-478-0652 / [info@mtdisplaysllc.com](mailto:info@mtdisplaysllc.com) / [www.mtdisplaysllc.com](http://www.mtdisplaysllc.com)