

FREE STANDING LEAFLET DISPLAY 4 CHANNEL



MULTIPLE VARIATIONS OF POSTER DISPLAYS AND BROCHURE HOLDERS

An ideal brochure stand that permits an indoor use of different models. The fixing grooves on four sides of the central pole hold single-sided or double-sided frames and shelves separately or collectively at the same time. The frames are recommended in 1.18" profiles to be used in both portrait or landscape position. The powder coated steel shelves are 0.047" thick and the clear acrylic shelves are 0.15". Each shelf has a 2x 8.5" X 11" capacity.

KEY SELECTION ATTRIBUTES

- * Free standing, four sided, decorative brochure stands for meeting different needs by utilizing multiple variations of display models at low cost.
- * Suitable for INDOOR public spaces with capacity of holding banners, single-sided or double-sided frames and shelves separately or collectively on four sides of the main pole for various poster & brochure sizes.
- * One main body set includes a robust pole made from 2.75"x2.75" anodised aluminium profile with 75.59" height and 4 slide-in channels on both sides, a heavy decorative base made from 2.75"x2.75" metallic gray RAL 9006 powder coated steel with 0.23" thickness for stability.
- * To complete a product, main body and required quantities of banners, poster frames and/or brochure holder shelves need to be ordered separately.
- * All poster frames, brochure holders and shelves with special codes are packed with fixing elements for sliding in the channels of four sides of the pole and fixing at desired height.
- * Frames with 1.18" profiles are recommended for use in portrait and landscape positions. Powder coated steel shelves with 0.047" thickness, clear acrylic shelves with 0.15" thickness, Ø9.84" circle and 9.84"x9.84" square shaped MDF shelves are available as optional accessories.
- * Optional acrylic logo header at 6.29" x 13.77" or 6.29" x 17.71" size and 0.118" thickness, is not included in original pack, should be ordered separately.
- * Make up your own stand in your desired variation. Heavy & stable base for public spaces.
- * Natural silver-anodized main body profile and poster frames, metallic gray powder coated steel base and transparent or powder coated shelves in standard. Custom colors also available, call for custom color requests.
- * Main body of Free Standing Leaflet Displays is packed unassembled in 2 boxes with an easy-to-understand instruction sheet & fixing elements. See info chart for pack sizes.



COLOURS IN STOCK



Silver

Black

COLOUR OPTIONS

Black Anodised

Silver Anodised

White - RAL 9003

Black - RAL 9005

Red- RAL 3020

Blue - RAL 5002

Green - RAL 6029

Yellow - RAL 1021

SUITABLE FOR

Free Standing Leaflet Displays can be used for INDOOR applications, for signage needs in many locations like shopping centers, markets, groceries, hotels, offices airports, shops and stores, hospitals, schools, apartments, restaurants, halls, meeting rooms, gas stations and many more.

WATCH VIDEO



Watch video at our website
www.mtdisplaysllc.com

FEATURES



EXPLODED VIEW



TECHNICAL DRAWING

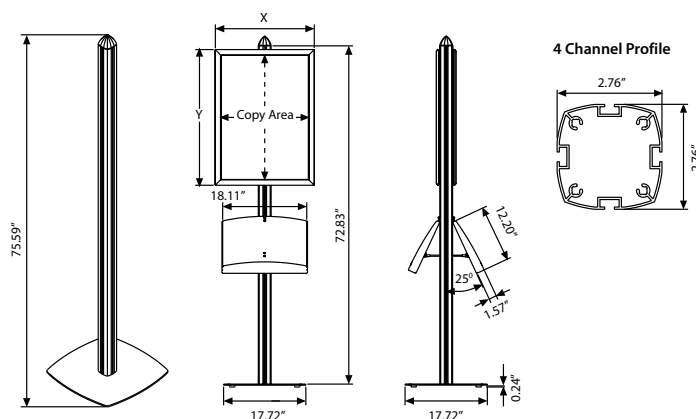

Some possible variations using 4 channel profile

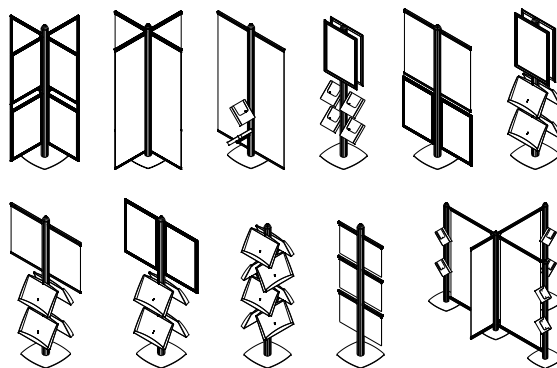

ARTICLES

| MAINBODY WITH 4 CHANNEL: Powder coated in RAL 9006 | | | | |
|--|----------------|------------------------|----------------------------|--|
| ARTICLE | DESCRIPTION | WEIGHT WITH PACKING | PACKING SIZE *W X H X D | |
| UFSL001100 | Main body pole | 7.605 lbs | 3.15" X 76.7" X 3.15" | |
| | Main body base | 19.731 lbs | 19.29" X 19.29" X 1.97" | |

OPTIONAL ACCESSORIES

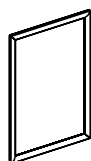

| SNAP FRAME: 1" 45° - 1" round | | | | | WEIGHT | PACKING SIZE |
|-------------------------------|---------------|-----------------|------------|-----------------|--------------|-------------------------|
| MITRED ARTICLE | ROUND ARTICLE | EXTERNAL (x-y) | POSTER | COPY | WITH PACKING | *W X H X D |
| UFSL000081 | UFSL010081 | 9.69" X 12.17" | 8.5" X 11" | 7.80" X 10.28" | 1.102 lbs | 10.63" X 12.20" X 0.83" |
| UFSL000017 | UFSL010017 | 12.17" X 18.19" | 11" X 17" | 10.28" X 16.30" | 1.873 lbs | 12.99" X 18.90" X 0.83" |
| UFSL000014 | UFSL010014 | 15.20" X 23.19" | 14" X 22" | 13.31" X 21.30" | 2.711 lbs | 16.54" X 24.41" X 0.83" |
| UFSL000018 | UFSL010018 | 19.21" X 25.50" | 18" X 24" | 17.32" X 23.31" | 2.645 lbs | 20.08" X 25.98" X 0.83" |
| UFSL000022 | UFSL010022 | 23.19" X 29.17" | 22" X 28" | 21.30" X 27.28" | 3.637 lbs | 24.02" X 30.31" X 0.83" |



| BANNER | | | WEIGHT | PACKING SIZE (20 Pcs) |
|------------|--------------|--------|--------------|------------------------|
| ARTICLE | EXTERNAL (x) | POSTER | WITH PACKING | *W X H X D |
| UFSL110011 | 11" | 11" | 11.904 lbs | 9.06" X 13.39" X 5.51" |
| UFSL110014 | 14" | 14" | 12.897 lbs | 17.32" X 9.06" X 5.51" |
| UFSL110018 | 18" | 18" | 17.504 lbs | 9.06" X 21.26" X 5.51" |
| UFSL110022 | 22" | 22" | 20.282 lbs | 9.06" X 25.20" X 5.51" |



T: +1 855-478-0652 / info@mtdisplaysllc.com / www.mtdisplaysllc.com

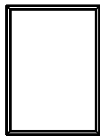

| SLIDE-IN FRAME | | | |
|----------------|-----------------|------------|-----------------|
| ARTICLE | EXTERNAL (x-y) | POSTER | COPY |
| UFSL130081 | 9.41" X 11.91" | 8.5" X 11" | 7.44" X 9.94" |
| UFSL130017 | 11.91" X 17.91" | 11" X 17" | 9.94" X 15.94" |
| UFSL130014 | 14.91" X 22.91" | 14" X 22" | 12.94" X 20.94" |
| UFSL130018 | 18.91" X 24.91" | 18" X 24" | 16.94" X 22.94" |
| UFSL130700 | 22.91" X 28.91" | 22" X 28" | 20.94" X 26.94" |

| WEIGHT | PACKING SIZE |
|--------------|--------------------|
| WITH PACKING | *W X H X D |
| 1.7 lbs | 9.4" X 13" X 1" |
| 2.6 lbs | 13" X 17.7" X 1" |
| 4 lbs | 17.7" X 24.8" X 1" |
| 6 lbs | 21.2" X 31.5" X 1" |
| 6.2 lbs | 21.2" X 28.8" X 1" |



| LEAFLET DISPENSERS : Clear Acrylic | | |
|------------------------------------|---------------|------------|
| ARTICLE | DESCRIPTION | SIZE |
| UFSL120000 | Acrylic Shelf | 8.5" X 11" |

| WEIGHT | PACKING SIZE |
|--------------|------------------------|
| WITH PACKING | *W X H X D |
| 0.904 lbs | 10.62" X 9.64" X 2.16" |



| SIDE SHELF : Clear Acrylic | | |
|----------------------------|---------------|----------------|
| ARTICLE | DESCRIPTION | SIZE |
| UFSL140000 | Acrylic Shelf | 8.5" X 11" |
| UFSL140100 | Acrylic Shelf | 5.83" X 8.27" |
| UFSL140200 | Acrylic Shelf | 1/3 8.5" X 11" |

| WEIGHT | PACKING SIZE |
|--------------|------------------------|
| WITH PACKING | *W X H X D |
| 1.83 lbs | 10.62" X 9.64" X 2.16" |
| 1.124 lbs | 9.64" X 7.67" X 2.16" |
| 0.739 lbs | 7.67" X 5.90" X 2.16" |

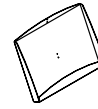

| STEEL & ACRYLIC SHELF | |
|-----------------------|------------------------------|
| ARTICLE | CAPACITY |
| UFSL002000 | 2 X 8.5" X 11" steel shelf |
| UFSL003000 | 2 X 8.5" X 11" acrylic shelf |

| WEIGHT | PACKING SIZE |
|--------------|-------------------------|
| WITH PACKING | *W X H X D |
| 3.968 lbs | 14.17" X 18.50" X 2.36" |
| 3.086 lbs | 14.17" X 18.50" X 2.36" |



| MATERIAL : Opaque acrylic | | |
|---------------------------|-------------|----------------|
| ARTICLE | DESCRIPTION | SIZE |
| UFSL120100 | Header | 13.77" X 6.29" |
| UFSL120200 | Header | 17.71" X 6.29" |

| WEIGHT | PACKING SIZE |
|--------------|------------------------|
| WITH PACKING | *W X H X D |
| 0.661 lbs | 7.67" X 14.37" X 0.86" |
| 0.661 lbs | 6.88" X 18.30" X 2.16" |

Shelf options: 1. model

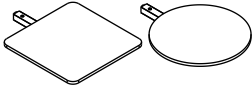

| SHELF OPTIONS 1: 0.31" MDF | | | |
|----------------------------|--------|---------------|-----------------|
| ARTICLE | MODEL | SIZE | WEIGHT CAPACITY |
| UFSL002500 | Circle | Ø 9.84" | max. 2.205 lbs |
| UFSL002510 | Square | 9.84" x 9.84" | max. 2.205 lbs |

| WEIGHT | PACKING SIZE |
|--------------|-------------------------|
| WITH PACKING | *W X H X D |
| 1.345 lbs | 10.23" X 13.77" X 1.37" |
| 1.554 lbs | 10.23" X 13.77" X 1.37" |

Shelf options: 2. model

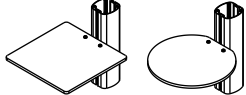

| SHELF OPTIONS 2: 0.31" MDF | | | |
|----------------------------|--------|---------------|-----------------|
| ARTICLE | MODEL | SIZE | WEIGHT CAPACITY |
| UFSL002550 | Circle | Ø 9.84" | max. 11.023 lbs |
| UFSL002560 | Square | 9.84" x 9.84" | max. 11.023 lbs |

| WEIGHT | PACKING SIZE |
|--------------|-------------------------|
| WITH PACKING | *W X H X D |
| 1.83 lbs | 10.62" X 11.22" X 4.13" |
| 2.227 lbs | 10.62" X 11.22" X 4.13" |

Material

Aluminium profile main body, steel base, 1.18" aluminium profile frames, steel shelves, MDF shelves and acrylic shelves.

Surface Finish

Natural silver-anodized main body, metallic gray RAL 9006 powder coated steel base, 1.18" natural silver-anodized profile frames, powder coated steel and MDF shelves and transparent acrylic shelves in standard. Custom colors also available, call for custom color requests.

Recycled Content

Up to 78% recycled content used.

Storage Conditions

Goods should be stored at 32°F to 77°F in a dry place. Store in the original package.

Warranty

All products are guaranteed for 3 years by MT Displays with below conditions:

[Warranty Conditions](#)

Installation Considerations

Main body of Free Standing Leaflet Displays is packed unassembled in 2 boxes with an easy-to-understand instruction sheet & fixing elements. See info chart for pack sizes. One main body set includes a robust pole made from 2.75"x2.75" anodised aluminium profile with 75.59" height and 4 slide-in channels on both sides, a heavy decorative base made from 2.75"x2.75" metallic gray RAL 9006 powder coated steel with 0.23" thickness for stability. To complete a product, main body and required quantities of banners, poster frames and/or brochure holder shelves need to be ordered separately. All poster frames, brochure holders and shelves with special codes are packed with fixing elements for sliding in the channels of four sides of the pole and fixing at desired height. Frames with 1.18" profiles are recommended for use in portrait and landscape positions. Powder coated steel shelves with 0.047" thickness, clear acrylic shelves with 0.15" thickness, Ø9.84" circle and 9.84"x9.84" square shaped MDF shelves are available as optional accessories. Optional acrylic logo header at 6.29" x 13.77" or 6.29" x 17.71" size and 0.118" thickness, is not included in original pack, should be ordered separately. Make up your own stand in your desired variation. Heavy & stable base for public spaces. Natural silver-anodized main body profile and poster frames, metallic gray powder coated steel base and transparent or powder coated shelves in standard. Custom colors also available, call for custom color requests.

Design Considerations

Free standing, four sided, decorative brochure stands for meeting different needs by utilizing multiple variations of display models at low cost. Suitable for INDOOR public spaces with capacity of holding banners, single-sided or double-sided frames and shelves separately or collectively on four sides of the main pole for various poster & brochure sizes.

Cleaning and Disinfecting

Clean your displays, with damp microfiber clothes, rinsed with simply water or warm, soapy or gentle shampooed water. Avoid using vinegar, abrasive, acidic, alcohol-based or heavy cleaners or cleaners containing Ammonia. Only after cleaning the product, if needed, simply apply disinfectant or sanitizer that is in compliance with your local guidelines and regulations.



INSTALLATION INSTRUCTIONS

Free Standing Leaflet Displays Main Body / 1003750

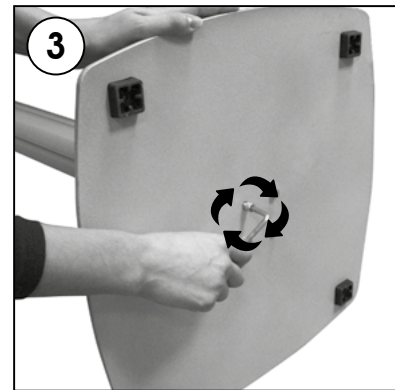
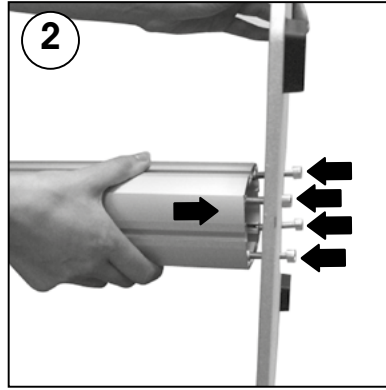
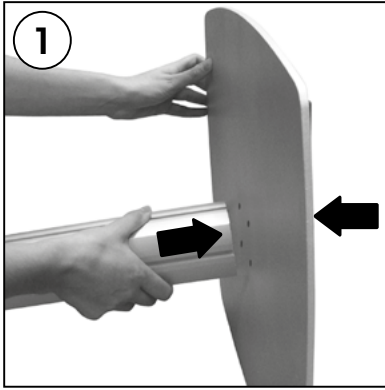

Each product includes

- 1 x Base
- 1 x Main body profile (4 channel)
- 1 x 5 allen key
- 4 x Bolt M6x30

- Please inform the order number on the product or on the carton (e.g. 1/110001394-460) to the place that you have made the purchase if any problem with the product occurs.
- All rights reserved. All pictures, figures and writings are secured internationally by copy-right law. Infringements will be sued by civil and legal law.

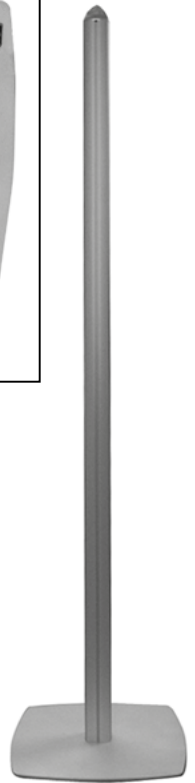

This technical sheet's contents are all subject to update and modification at MT Displays' exclusive discretion. There is nothing official about this document. For final and legally binding information, please get in touch with the sales staff at MT Displays.



T: +1 855-478-0652 / info@mtdisplaysllc.com / www.mtdisplaysllc.com