

DECORATIVE BROCHURE STAND



FREE STANDING BROCHURE HOLDERS WITH ACRYLIC TOP SHELF

Decorative Brochure Stand is available in 8.5" x 11" size. It is easy to change top header in portrait & landscape positions. Height is 38.18" in landscape position and 39.37" in portrait position. It has a perfectly convenient size in both portrait and landscape positions. Equipped with sturdy decorative powder coated base. Soft feet prevent the product sliding and the surface scratching. It is ideal for exhibition, museum, conference and showroom areas. Decorative Brochure Stand adds value to your brand's announcements or information brochures. Its modern and qualified look ensures your brands and its announcement attracts the attention deserve.

KEY SELECTION ATTRIBUTES

- * Free standing, decorative brochure holders with an acrylic top shelf.
- * Suitable for INDOOR public spaces with two shelf versions for holding 8.5" x 11" size brochures in portrait and landscape positions.
- * One set includes an acrylic transparent shelf suitable for holding 8.5" x 11" brochures in portrait or landscape positions, 2"x1" anodized aluminium main body profile with 38.18" height for landscape version and 39.37" height for portrait one, 12.99"x9.84" metallic gray RAL 9006 powder coated decorative base with 3.571" weight for stability, 1 shelf connector, 2 bolts M6x1", 2 bolts M6x1.96", 4 screws, 1 allen key (0.15") and 1 allen key (0.19") for fixing.

- * Soft feet prevent the product sliding and the surface scratching.
- * Natural silver-anodized main body profile, metallic gray powder coated steel base and transparent shelf in standard. Custom colors also available, call for custom color requests.
- * Decorative brochure stand is packed unassembled in 2 boxes with an easy-to understand instruction sheet & fixing elements. See info chart for pack sizes. Assembly in 60 seconds.



8.5" x 11" landscape



8.5" x 11" portrait



COLOURS IN STOCK

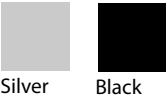

SUITABLE FOR

Brochure Sets can be used for INDOOR applications, for displaying brochures in many locations like shopping centers, markets, groceries, hotels, offices airports, shops and stores, hospitals, schools, apartments, restaurants, halls, meeting rooms, gas stations and many more.

WATCH VIDEO



Watch video at our website www.mtdisplaysllc.com

FEATURES



EXPLODED VIEW

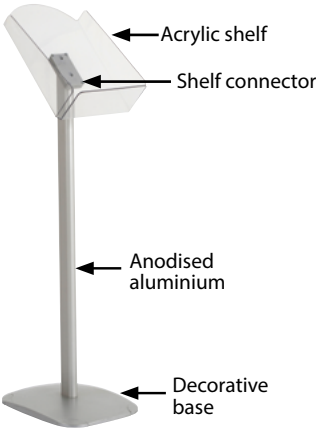

TECHNICAL DRAWING

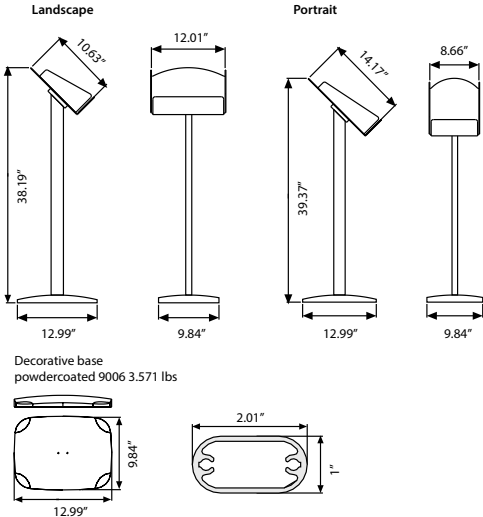

ARTICLES

ARTICLE	DESCRIPTION	WEIGHT	PACKING SIZE
		WITH PACKING	*W X H X D
UDBS10Y0A4	8.5" X 11" landscape	8.774 lbs	11.02" X 34.65" X 4.92"
UDBS10D0A4	8.5" X 11" portrait	8.774 lbs	11.02" X 34.65" X 4.92"

PHYSICAL DATA

Material
Main body made from aluminium profile, steel base and acrylic shelf.

Surface Finish
Natural silver-anodized main body, metallic gray RAL 9006 powder coated steel base and transparent shelf in standard. Custom colors also available, call for custom color requests.

Recycled Content
Up to 78% recycled content used.

Storage Conditions
Goods should be stored at 32°F to 77°F in a dry place. Store in the original package.

Warranty
All products are guaranteed for 3 years by MT Displays with below conditions:
[Warranty Conditions](#)

Installation Considerations
Decorative brochure stand is packed unassembled in 2 boxes with an easy-to-understand instruction sheet & fixing elements. See info chart for pack sizes. Assembly in 60 seconds. One set includes an acrylic transparent shelf suitable for holding 8.5" x 11" brochures in portrait or landscape positions, 2"x1" anodised aluminium main body profile with 38.18" height for landscape version and 39.37" height for portrait one, 12.99"x9.84" metallic gray RAL 9006 powder coated decorative base with 3.571" weight for stability, 1 shelf connector, 2 bolts M6x1", 2 bolts M6x1.96", 4 screws, 1 allen key (0.15") and 1 allen key (0.19") for fixing. Soft feet prevent the product sliding and the surface scratching.

Design Considerations
Free standing, decorative brochure holders with an acrylic top shelf. Suitable for INDOOR public spaces with two shelf versions for holding 8.5" x 11" size brochures in portrait and landscape positions. with two shelf versions for holding 8.5" x 11" size brochures in portrait and landscape positions.

Cleaning and Disinfecting
Clean your displays, with damp microfiber clothes, rinsed with simply water or warm, soapy or gentle shampooed water. Avoid using vinegar, abrasive, acidic, alcohol-based or heavy cleaners or cleaners containing Ammonia. Only after cleaning the product, if needed, simply apply disinfectant or sanitizer that is in compliance with your local guidelines and regulations.



INSTALLATION INSTRUCTIONS

Decorative Brochure Stand / 1002019

Each product package includes mounting accessories:

- 1 column
- 1 column body profile
- 1 column
- 1 column connector
- 2 column base
- 2 x 10x10x10 mm
- 4 x 10x10x10 mm
- 1 x 10x10x10 mm
- 1 x 10x10x10 mm

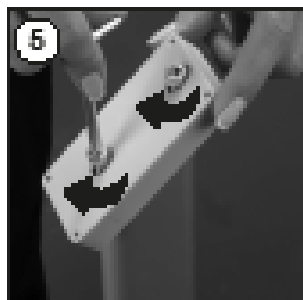
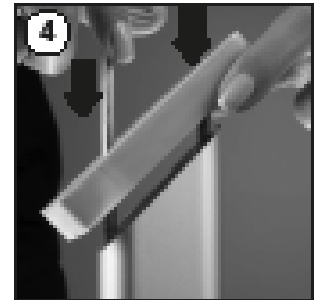
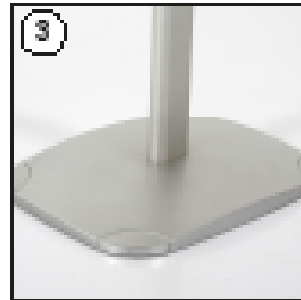
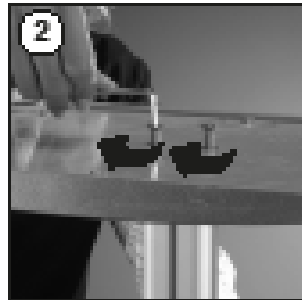
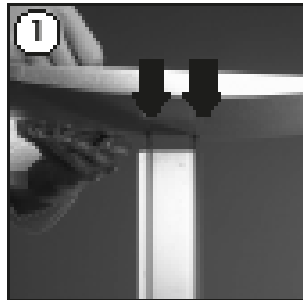

Portrait

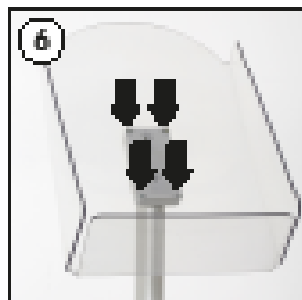

Landscape

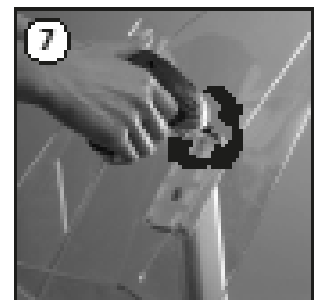
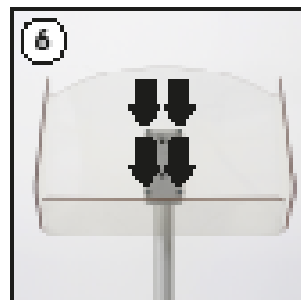

- Please insert the order number on the product or on the carton (e.g. 1/110001304-050) to the place that you have made the purchase if a problem with the product occurs.
- All rights reserved. All pictures, figures and settings are secured internationally by copyright law. Infringements will be sued by civil and legal law.

This technical sheet's contents are all subject to update and modification at MT Displays' exclusive discretion. There is nothing official about this document. For final and legally binding information, please get in touch with the sales staff at MT Displays.



T: +1 855-478-0652 / info@mtdisplaysllc.com / www.mtdisplaysllc.com